

Saint Mary's University Art Gallery  
Floor Plan

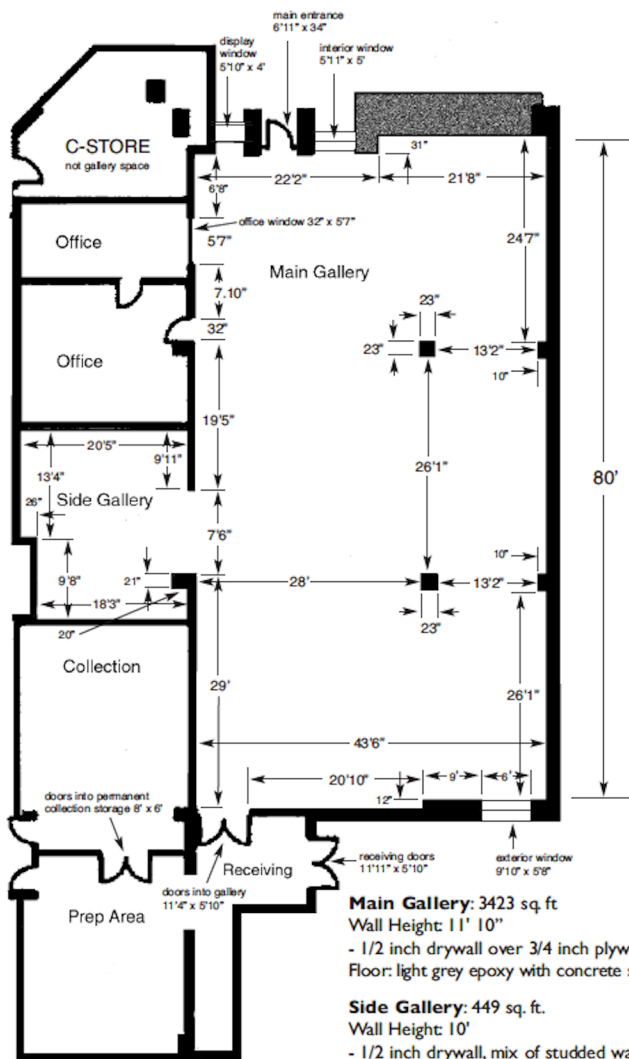

**Portable Walls:**  
Two  
156" x 24" x 119"  
(LxWxH)  
fit between pillar  
and wall pillar, but  
can be placed any-  
where in gallery

**Main Gallery:** 3423 sq. ft.

Wall Height: 11' 10"

- 1/2 inch drywall over 3/4 inch plywood throughout  
Floor: light grey epoxy with concrete subfloor

**Side Gallery:** 449 sq. ft.

Wall Height: 10'

- 1/2 inch drywall, mix of studded wall and concrete subwall;  
Floor: light grey epoxy with concrete subfloor